

# THREE OAKS DEVELOPMENT

SECTION 6,7 & 82, TOWNSHIP 16S, RANGE 17E  
 COASTAL PHOENIX INVESTMENTS/AFFORDABLE HOUSING LLC, DEVELOPERS  
 KYLE ASSOCIATES, LLC, PLANNER / ENGINEER

144 ACRES AREA	229 NO. OF LOTS	PUBLIC SEWER SYSTEM	NONE ZONING	5 NO. OF PHASES
6,000 SQ. FT. MIN. LOT SIZE	20 FT STREET WIDTH	PUBLIC WATER SYSTEM	ASPHALT ROAD SURFACE	15274 LN. FT. STREET LENGTH

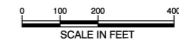

DESIGNED BY: BCN	DRAWN BY: MM/TM	CHECKED BY: FMK	JOB NO.: 40944
SCALE: (1"=117')	SCALE: (1"=400')	DATE: OCT 2009	

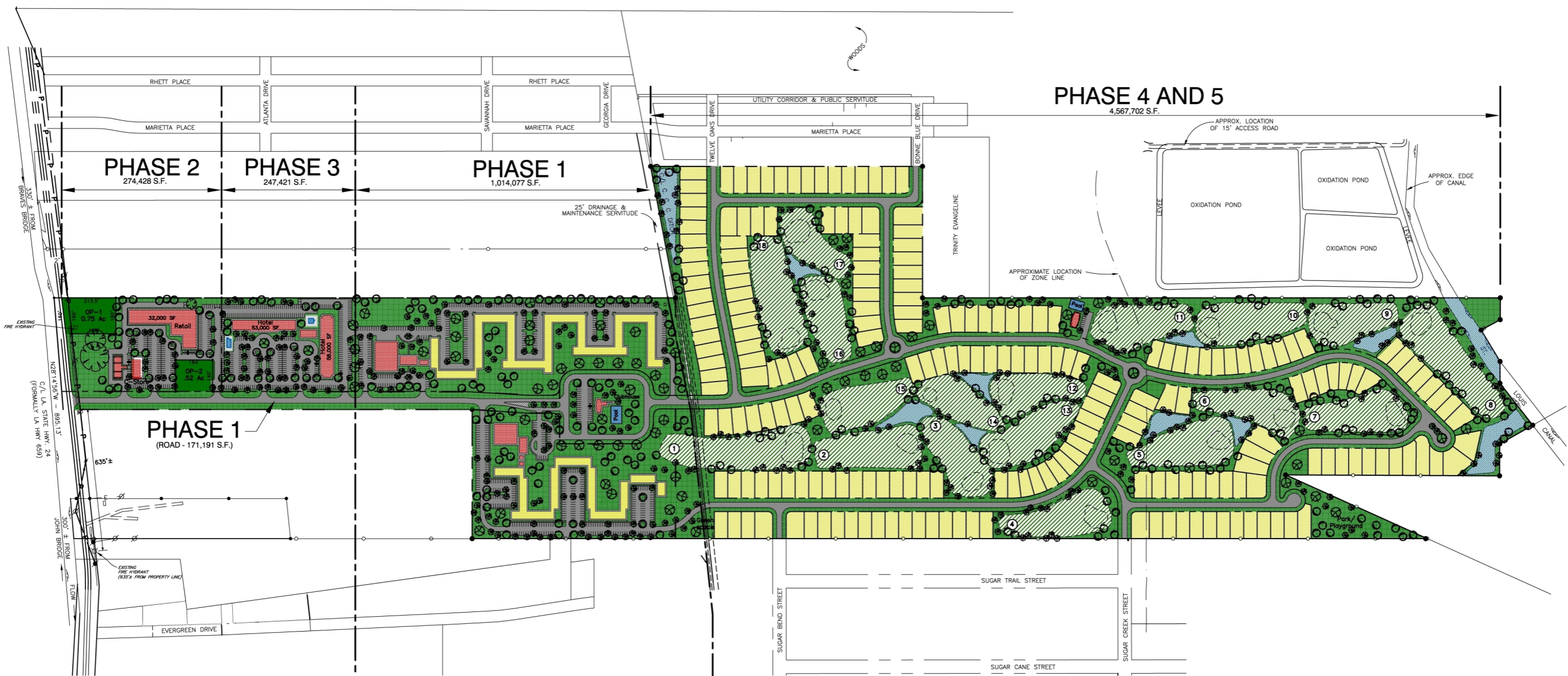

← COMMERCIAL →

← MULTI FAMILY →

← SINGLE FAMILY / GOLF COURSE →

- NOTES:
1. FIRE HYDRANTS TO BE PROVIDED EVERY 300' IN COMMERCIAL AREAS AND 400' IN RESIDENTIAL AREAS.
  2. FIRE FLOW CALCULATIONS TO BE PROVIDED DURING THE DESIGN PROCESS.
  3. ALL FIRE HYDRANTS WILL BE ACCESSIBLE FROM THE STREET RIGHT OF WAY.

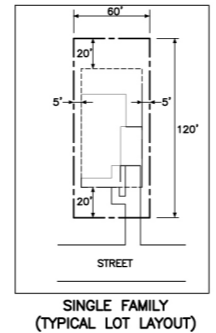

LEGEND:

- PROPERTY LINE
- BUILDING
- GOLF COURSE

COMMERCIAL	4 LOTS
MULTI-FAMILY BLDG	335 UNITS 2 LOTS
S/F LOTS	223 UNITS

**PRELIMINARY PLAN**  
 NOT FOR CONSTRUCTION

DATE:	REVISIONS:	APPROVED:
REMARKS:		

STAMP:

**KYLE ASSOCIATES, LLC**  
 Planning • Civil Engineering • Landscape Architecture  
 638 Village Lakes N., Metairie, LA 70001 • 504.887.9377

SHEET NO.  
**1**  
 1 OF 1

N:\2009\40944 - Three Oaks Development-(Terrebonne Tract)\Misc Graphic Images\Drawings\1) Plans\409XX-PL-Site Color Revised2.dwg, 11/16/2009 8:18:34 AM, mmajnerick